



Cricket Reel - Lot 43

1167 Grayson Drive
Greenfield, IN 46140

3,018 square feet

(First Level 2378 sq. ft., Bonus Room 640 sq. ft.)

Features:

- **Three Car Garage** (730 sq. ft.—crawl access)
- **Split Floor Plan**
- **Concrete Patio** (18 x 16)
- **Exterior**
 - Brick and Hardy Plank Siding
 - Rockwell Windows—white aluminum clad exterior, wood interior. Casement front, double-hung back and sides
- **Interior**
 - Painted woodwork
- **Foyer** (11 x 8)
 - Closet with niche & plant shelf
 - 11' ceiling
 - Tile Floor
- **Great Room** (23 x 16)
 - Cathedral Ceiling
 - Direct Vent Fireplace
 - Carpet
- **Dining Room** (12 x 12)
 - Arched Entryways
 - 11' Ceiling
 - Carpet Floor
- **Kitchen** (13 x 13) and **Nook** (13 x 11)
 - Cathedral Ceiling
 - Tile Floor
- **Sun Room** (14 x 13)
 - Cathedral Ceiling
 - Arched Columns
 - Tile Floor
- **Half Bath** (5 x 5)
 - Pedestal Sink
 - Elongated Toilet
 - Tile Floor
- **Laundry Room** (9 x 9)
 - Laundry Sink
 - Folding Table
 - Door to Master Closet
- **Master Bedroom** (15 x 16)
 - Trey Ceiling
 - Ceiling Fan/Light
 - Carpet
 - Master Bath**
 - 6' Whirlpool Tub
 - 72" Double Sink Vanity
 - 4' Fiberglass Shower
 - Elongated Toilet
 - Tile Floor
 - Master Closet** (10 x 9)
 - Carpet Floor
- **Bedroom #2** (16 x 12)
 - Carpet
- **Bedroom #3** (16 x 12)
 - Carpet
- **Bath #2** (8 x 5)
 - Vaulted Ceiling with Skylight
 - 5' Tub/Shower
 - 36" Vanity
 - Tile Floor
- **Bonus Room** (27 x 14)
 - 3 Attic Access Areas
 - Full Bath (9 x 7) with Tile

For more information about
this house and others,
please call
Jim Swanson
339-3640 or 462-8806

Front Elevation



First Floor 2378 sq. ft.

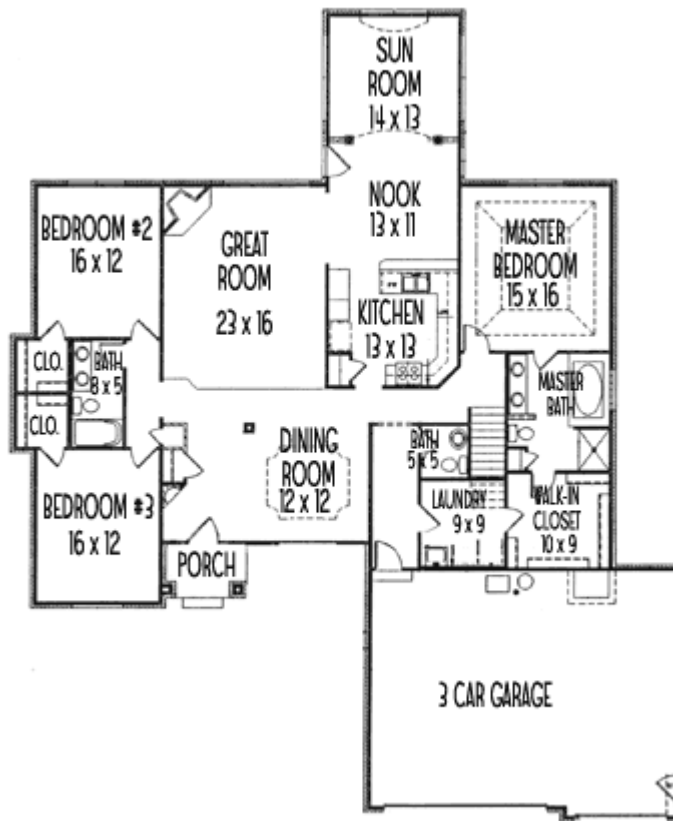

Bonus Room 640 sq. ft.

